

STERLING

# Double Roll Bath Tissue Dispenser

No run-out and no stub roll waste!



**#52007**

This attractive and versatile easy-loading model holds a fresh roll of standard tissue in reserve and uses rolls sequentially to eliminate stub roll waste. Space saving over/under design for all Away From Home applications.

## **USER SATISFACTION**

- Double roll to prevent running out of paper!
- Easy operation—just push back on the empty core for new roll to drop down

## **HYGIENIC PERFORMANCE**

- Double roll and high capacity ensure paper is always available

## **UPSCALE IMAGE**

- Attractive all-plastic model avoids rust and stains
- Black smoke cover/black back to blend with any washroom design

## **EASY MAINTENANCE**

- Simple three-piece design with standard mounting bracket for easy installation
- Quick and intuitive to load with patented mandrel and self-alignment
- Easy clean, sloping surfaces that prevent placement of cigarettes and litter

## **ECONOMY**

- Superior value for an economical price
- Durable all plastic unit eliminates rust for long-lasting performance

## **LOWER COST IN USE**

- Rolls are used sequentially to eliminate stub roll waste
- Brake on mandrel reduces overuse
- Cover hinged at bottom and locks with standard key or snap-in fixed key to prevent pilferage





STERLING

# Double Roll Bathroom Tissue Dispenser

**The Double Roll Bathroom Tissue Dispenser is versatile and economical to fit your needs.**

- Mounting hardware is included; optional mounting plate available
- Removable and fixed keys provided
- Universal "C" mandrel

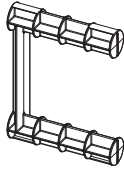

## Specifications:

Unit Dimensions:	13-1/2" x 6" x 6-1/2" (34cm x 15cm x 17cm)
Weight:	2 lbs (.91kg)
Finish/Color:	Black smoke cover/black back
Paper Capacity:	2 rolls
Roll Width:	4.5" (11.4cm) maximum
Roll Diameter [Max]:	5-3/4" (15cm)
Units per Case:	1
Cases per Pallet:	105
Case size:	6-7/8" x 6-1/8" x 14-1/4" (17cm x 16cm x 36cm)
SKU:	52007



Distributed by: